

THIS PLAN IS NOT TO BE CONSIDERED AS A TRUE OR ACCURATE REPRESENTATION

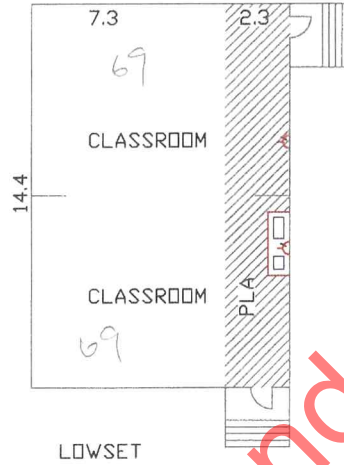

Released under the RTI Act

AS BUILT



Revise on CAD. Do not amend by hand

No.	ISSUE / REVISION	ENGINEER APPROVED	DATE	W/FILM
1	AS BUILT	*BWK	3.4.00	
0	ORIGINAL ISSUE	*BWK/*BJS	29.1.99	



Department of Education, Queensland
Building Better Schools

Copyright - This document shall remain the property of Gutteridge Haskins & Davey Pty Ltd. The document may only be used for the purpose for which it is considered & in accordance with the terms of engagement for the construction of this document. In any way is prohibited.



Gutteridge Haskins & Davey Pty Ltd
 CONSULTING ENGINEERS, ENVIRONMENTAL SCIENTISTS & PLANNERS PROJECT MANAGERS
 ACN 008 490 373

Brisbane 15 York Terrace QLD 4000 Telephone (07) 2558 3668
 GPO Box 668 Brisbane QLD 4001 Facsimile (07) 3038 4592

SCALE	1:200 (FULL SIZE A3)
DRAWING CHECKED	*MVC
ENGINEER DESIGN	*BWK
DRAFTING CHECK	*BWK
ENGINEER CHECK	*SB
APPROVED	*B.J. SOWRY

CLIENT AND JOB	BUILDING BETTER SCHOOLS CAPRICORN REGION
TITLE	BLUFF STATE SCHOOL MODULAR B - PROPOSED REFURBISH
SIZE	A3
Dr No.	9-07-0344-01
Rev	1